

PART 2
AREA=59.7ha

PART 1
AREA=4,876m²
(TO MERGE
WITH PART 3)

SUBJECT TO TRANS CANADA PIPELINE EASEMENT

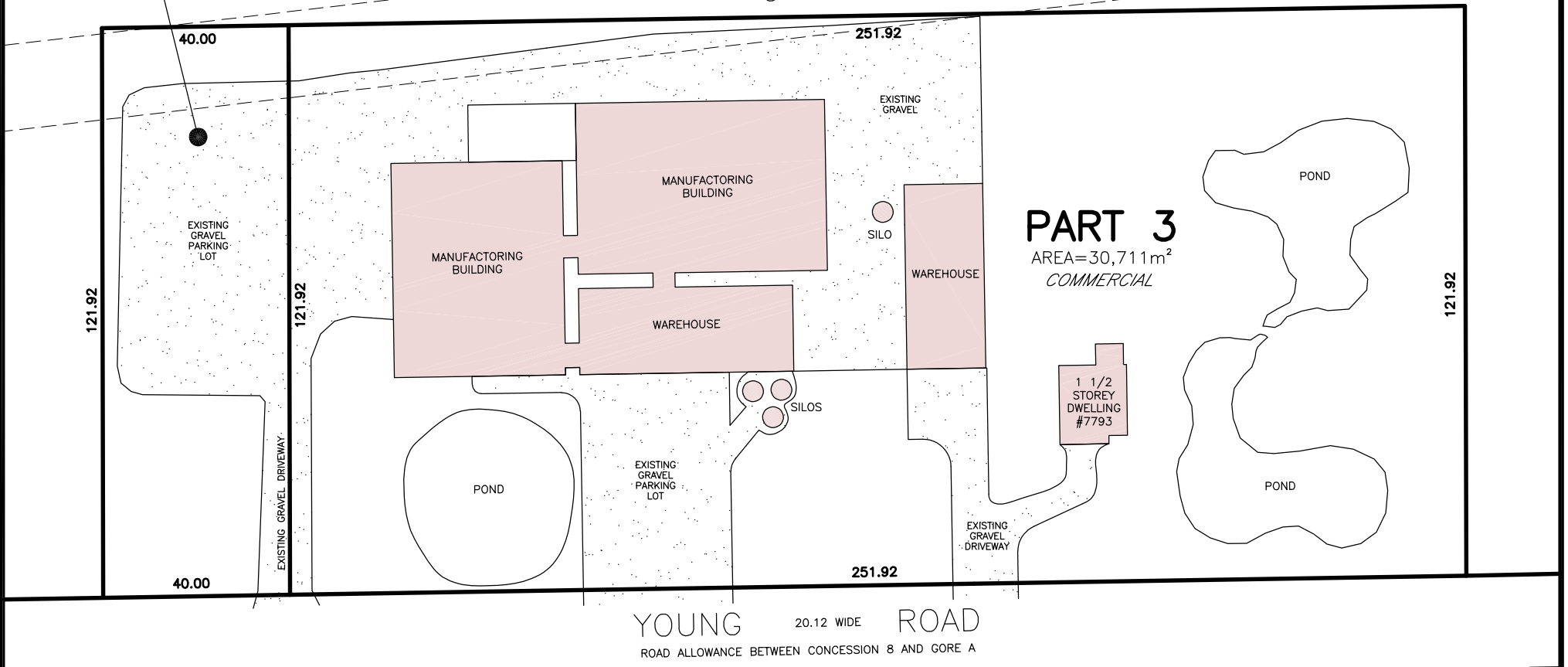

SKETCH

PREPARED FOR CONSENT APPLICATION
PART OF LOTS 14 AND 15 AND PART
OF THE ROAD ALLOWANCE BETWEEN LOTS
14 AND 15 – GORE A
GEOGRAPHIC TOWNSHIP OF SOUTH GRIMSBY
IN THE
**TOWNSHIP OF
WEST LINCOLN**
REGIONAL MUNICIPALITY OF NIAGARA
SCALE 1 : 1,250 (METRIC)

NOTE: THIS SKETCH IS PREPARED FROM COMPILED AND
CALCULATED INFORMATION, NOT FROM AN ACTUAL SURVEY.
DO NOT SCALE FROM THIS DRAWING.
ALL MEASUREMENTS ARE +/- MEASUREMENTS.

CAUTION: THIS IS NOT A PLAN OF SURVEY AND SHALL NOT BE
USED EXCEPT FOR THE PURPOSE INDICATED IN THE TITLE BLOCK.

"THIS IS NOT AN ORIGINAL COPY UNLESS EMBOSSED WITH SEAL."

© COPYRIGHT 2024
THE REPRODUCTION, ALTERATION OR USE OF THIS SKETCH, IN
WHOLE OR IN PART WITHOUT THE EXPRESS WRITTEN PERMISSION OF
CHAMBERS AND ASSOCIATES SURVEYING LTD. IS STRICTLY PROHIBITED.

Feb. 7, 2024
DATE

Don Chambers
DONALD G. CHAMBERS, B. Sc., O.L.S.

**CHAMBERS AND ASSOCIATES
SURVEYING LTD**

12 THOROLD ROAD EAST (905) 735-7841 / 735-7844
WELLAND ONTARIO FAX (905) 735-7333
L3C 3T2 www.casl-surveying.com

DWG 24001_SEV FILE 24-01

